

SUITE 110

RELOCATED FEC

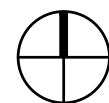

Suite #110

SCALE: 3/16" = 1'-0"
(11 x 17 PAPER)

2,216 RSF

Legend:

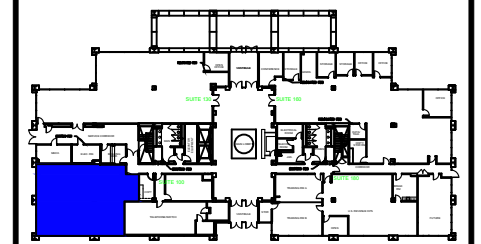

KEY PLAN

no.	issue	date

Title: **First Floor**

Scale: N.T.S.

Drawn By: _____

Date: 02-26-2016

Project Name and Location:
**2003 Corporate Avenue
Memphis, TN 38132**

Suite/Room #
110



OLYMBEC
USA
1004 East Brooks Road
Memphis, TN 38116
Tel: 1-888-OLYMBEC
WWW.OLYMBEC.COM

*Note That All Dimensions Are Approximate and subject to change without notice