

G:\Cad Files\Corporate Avenue 2005 Corporate Plaza, Memphis, TN\2005- Building - Olymbec.dwg, 3/25/2021 10:07:14 AM, Icarisile, Olymbec, Olymbec

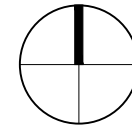
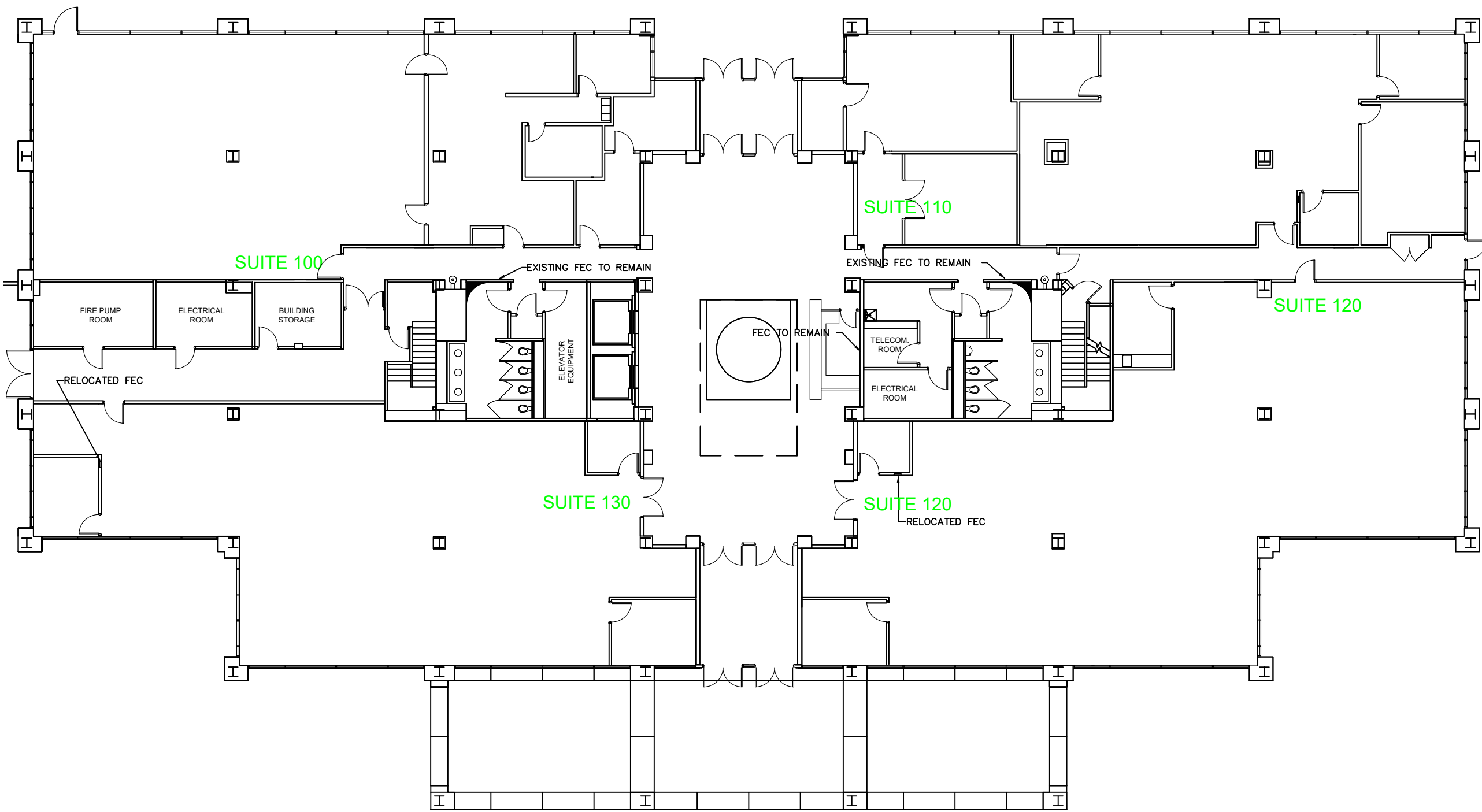

First Floor Plan
SCALE: NTS (11X17)

16,400 RSF

Legend:

no.	issue	date

Title:
First Floor Plan

Scale: N.T.S.
Drawn By:
Date:

Project Name and Location:
**2005 Corporate Avenue
Memphis, TN 38132**
Suite/Room #



*Note That All Dimensions Are Approximate and subject to change without notice